

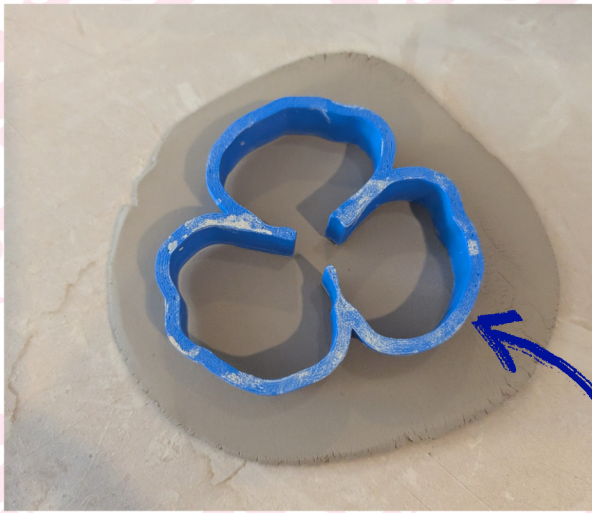

Make a
Poppy
with me...

Cutters For Clay

www.cuttersforclay.co.uk



1. Roll out your clay to 3/4mm thick and use the cutter to cut out 2 layers of poppy petals

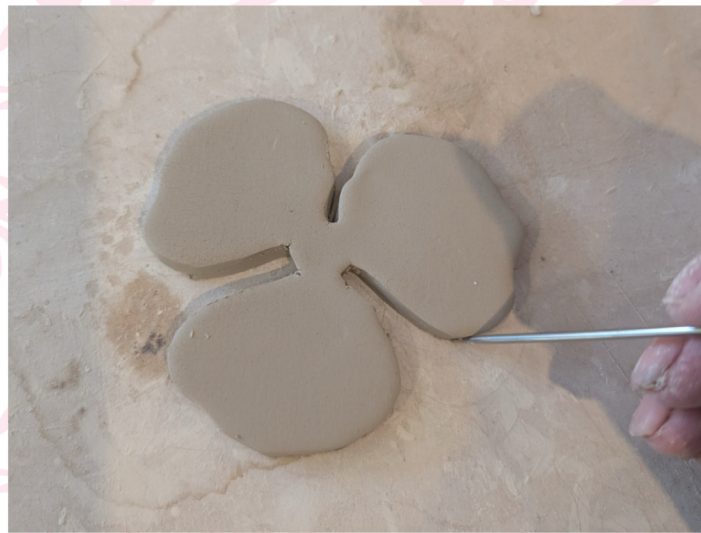

2. Use a needle tool to tidy up the edges

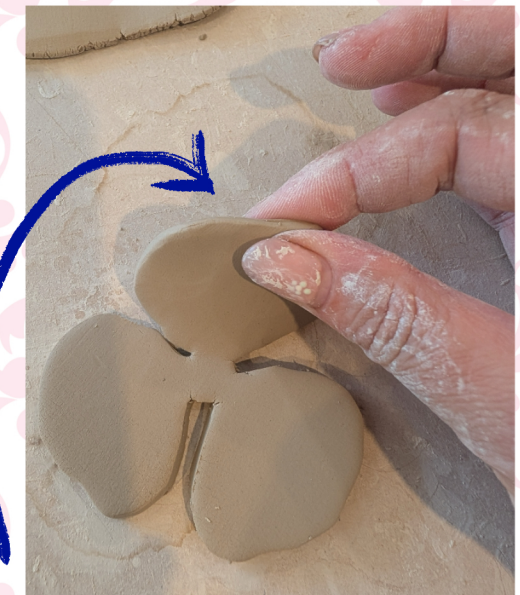

3. Pinch the petals to soften the edges



4. This should give your petals a more natural look

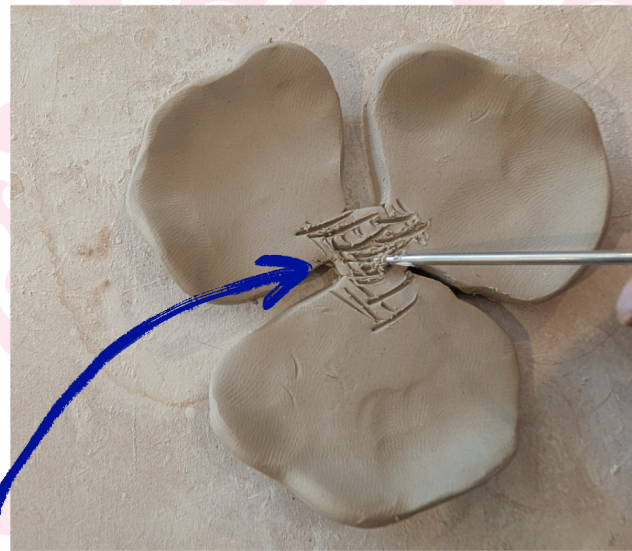

5. Score the middle of one layer - this will be your base

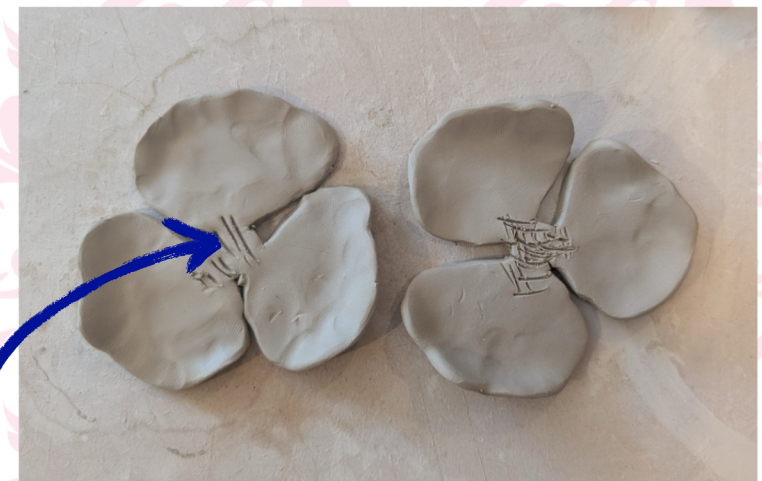

6. Score the 'back' of the other petal layer, this will be flipped over and be your top layer



7. Paint slip onto the middle of your base piece



8. Attach your 2 layers together so that the petals are staggered



9. Use a damp paintbrush to blend where the petals overlap

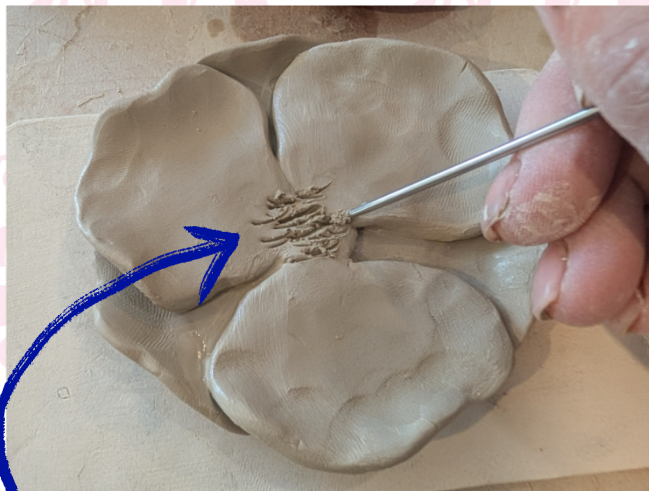

10. Score the middle of your poppy

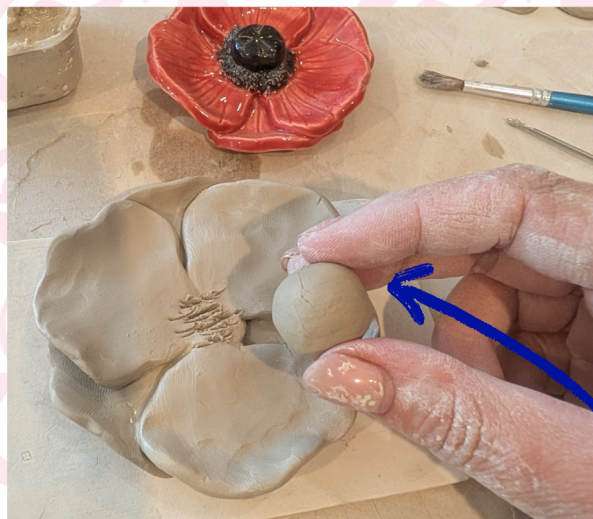

11. Roll a ball of clay big enough to cover the middle of the poppy



12. Shape the ball of clay between your finger and thumb, flattening the edges



13. Form into a slightly tapered shape with one end wider than the other

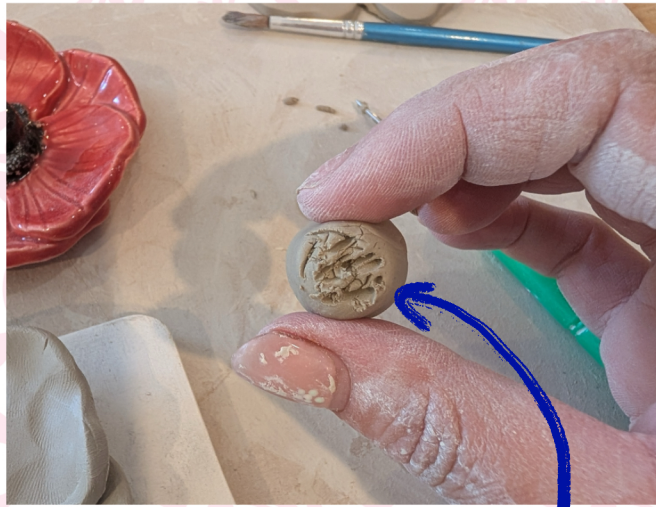

14. Score the narrower end

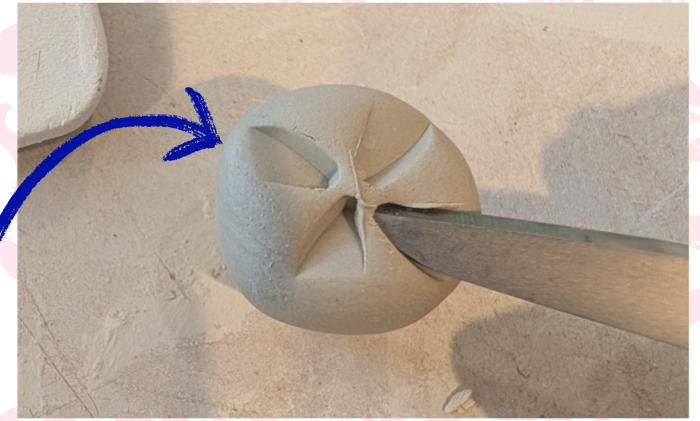

15. Use something flat to texturise the wider top. Here we've used the tip of a scissor blade

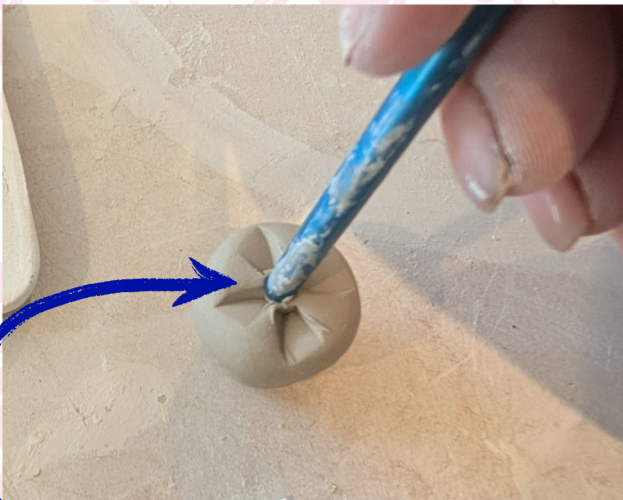

16. Use the end of a paintbrush to make an indent in the middle

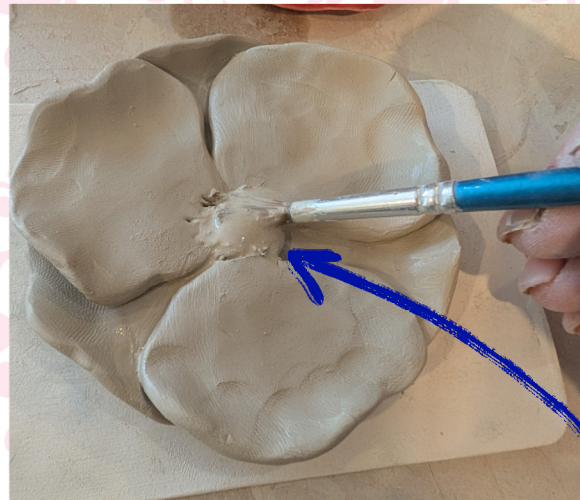

17. Paint slip onto the scored area of the middle of the poppy



18. Firm the middle of the poppy in place and smooth the join with a damp paintbrush

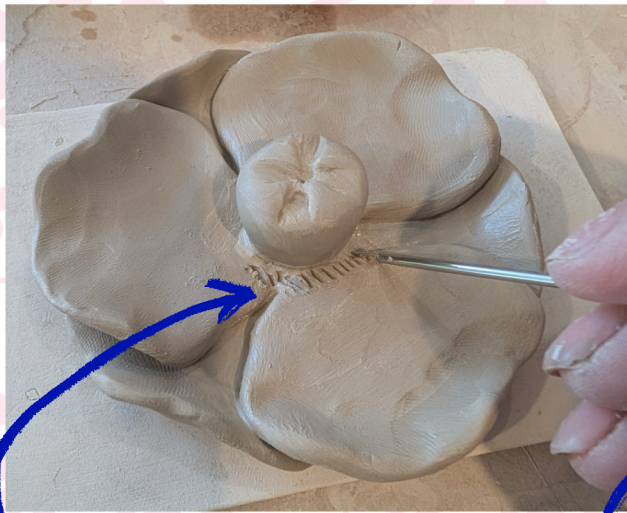

19. Score a small circle around the middle of the poppy



20. There's a few options to finish the middle of your poppy. For this one, roll several mini balls of clay

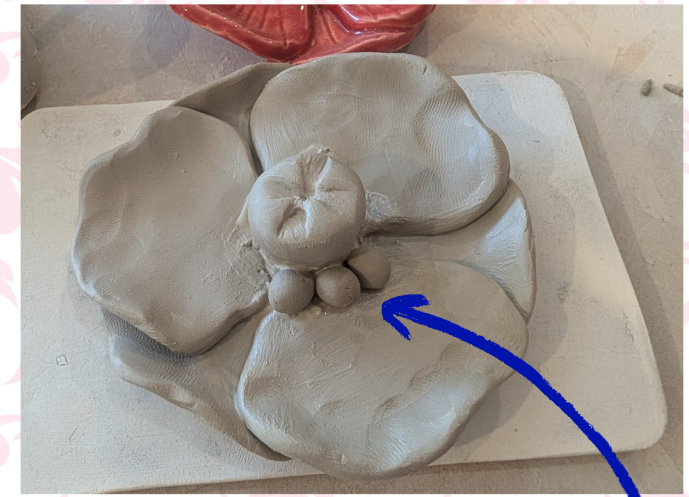

21. Paint slip around the middle of the poppy and firm the balls of clay in place



22. Continue this all around the middle of the poppy

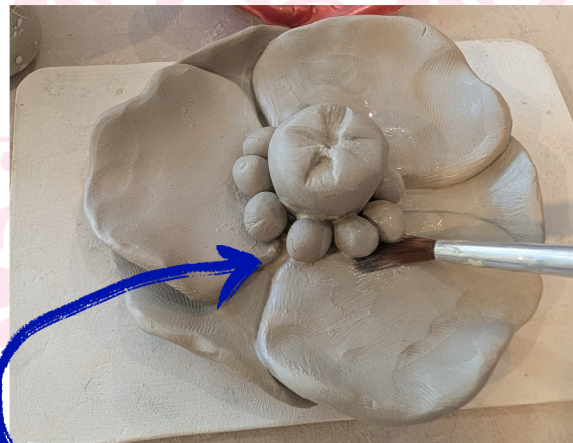

23. Use a damp paintbrush to smooth the join



24. Ta-dah! You have your poppy!



25. For the other option to finish the middle, you'll need a fine sieve or tea strainer and a small amount of clay



26. Push the clay through the sieve or tea strainer

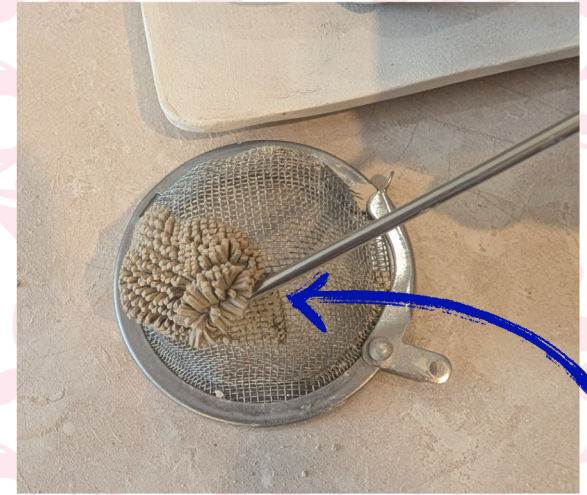

27. Use a needle tool to pick up the clay away without misshaping it too much

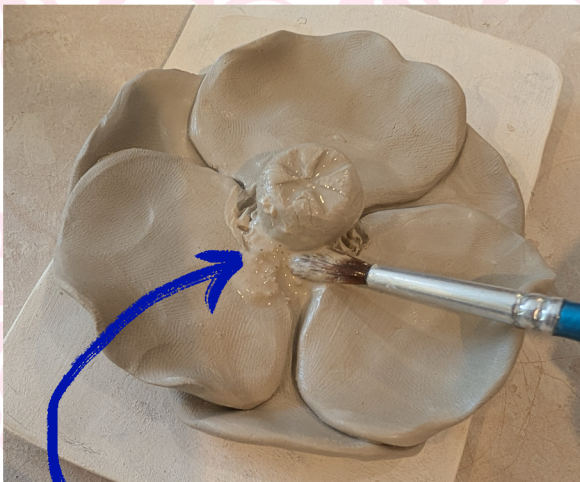

28. Paint slip around the scored middle of the poppy

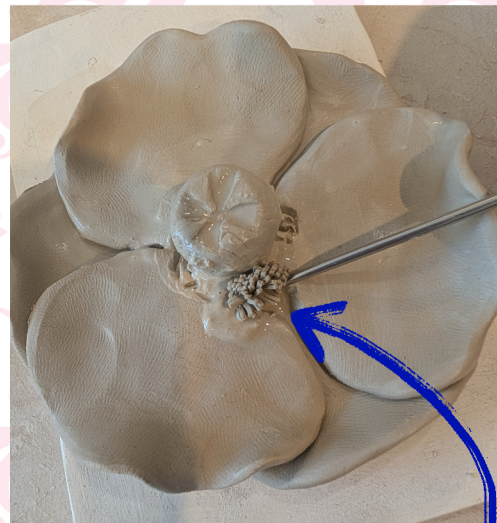

29. Attach the textured clay directly from the needle tool onto the slipped area



30. Continue this all the way around, then use a damp paintbrush to get the texture you want. Then ta-dah, your poppy is finished!

