

Make a Mug with me...



Cutters For Clay

www.cuttersforclay.co.uk



1. Roll out your clay to 7mm thick - we've used our handy clay spacers to help here



2. If you're adding texture to your clay, do this first then use our mug cutter set to cut out one base and one wall piece

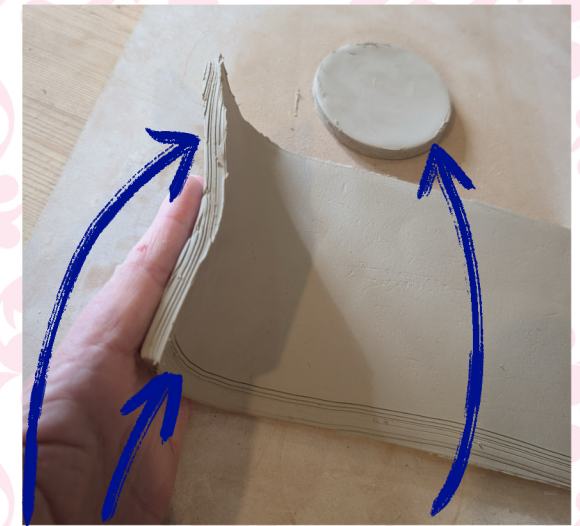

3. Score around the circular base, the short edges of the wall and inside the long side of the wall as shown here



4. Add slip along the long edge of your wall



5. Roll out 3 sausages of clay. 1 the length of the long edge of your wall and 2 the length of the short edge of your wall



6. Stand up your walls around the base and start to wrap around. Add the long sausage along the seam line and start to blend in - half into the base and half into the walls



7. Continue until you get to the stage shown here... then paint slip onto the short edges



8. Continue to close your walls and push the short edges together. Finish blending the long sausage on the inside of your mug



9. Gently flatten one of the short sausages and place on the outer seam. Blend this in completely

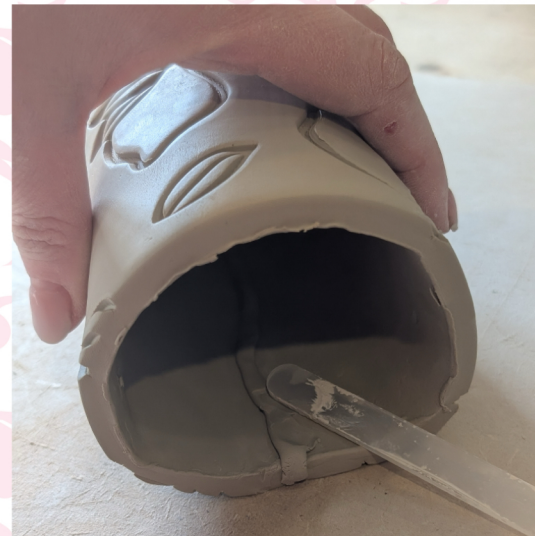

10. Repeat with the 2nd short sausage on the inner seam. Keep the seam line flat on the table to give one support



11. Flip your mug upside down and blend the seam line into the base



12. Your mug may have lost its shape a little so use our pot former to straighten up the sides



13. If you want to keep your mug with straight sides leave it as it is. Or...



... if you want to add a belly to your mug, use our muggler tool to stir around inside the pot to push the shape out



14. Shape the rim of your mug. Smooth over the sharp edges and shape out as desired



15. Time to make your handle... there's lots of ways you can do this but here's a few options...

- 1) Roll out a this sausage of clay and gently flatten
- 2) Roll out a clay to your desired thickness then use a ruler or our clay spacer to cut out the handle



16. Here we've added an indentation on the end of the handle where it'll join with the mug by making a firm thumb print



17. Use a craft knife or needle tool to round off the edge of your handle



18. Flip over the handle and on the opposite end repeat the step 16&17 to make an indentation and round off the edge



19. Score your handle on both sides behind where you have made your indentation as this'll be where the handle is attached to your mug



20. Pop your handle into this shape and leave to firm up for a bit

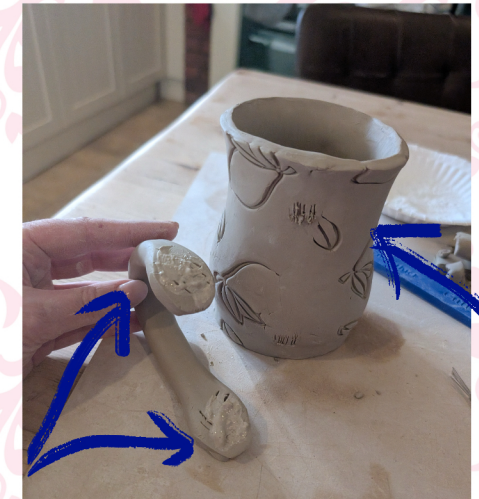

21. Put some slip onto the scored areas of your handle and score on your mug where you will attach the handle



22. Attach your handle and squeeze firmly into place, supporting the shape of your mug from the inside



23. Use our rim cone to ensure the rim is circular



24. Ta-dah! Now you have your mug!



Stay Wild